



[sales@orientinsulators.com](mailto:sales@orientinsulators.com)  
<http://www.suspensioninsulators.com>

# **Chapter 4**

## **Suspension Insulator Coupling Method**

---

4.2 Types of End Fitting for Composite  
Suspension Insulator

**By Orient Power**

# Types of end fitting for composite insulator

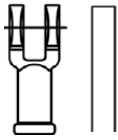
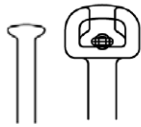

**Orient Power**

[sales@orientinsulators.com](mailto:sales@orientinsulators.com)

<http://www.suspensioninsulators.com>

## ✚ The composite insulator end fittings types:

The composite insulator end fitting types can be classified as Ball, Socket, Tongue, Clevis, Y-type, Eye, these names of the end fittings are named by their shape.

## ✚ The combination of the end fitting for composite suspension insulator:

- Ball and socket
- Ball and eye
- Ball and Y-clevis
- Eye and eye
- Clevis and tongue
- We can also make the combination according to the requirement of the clients.

## ✚ The composite insulator end fitting standard:

IEC 60120 has detailed design for ball and socket end fitting

16mm A

16mm B

20mm

24mm

ANSI C29.12 has detailed design for other types of end fitting such as Y clevis, eye type.

## ✚ Production method of end fitting for composite insulator:

- Casting
- forging